

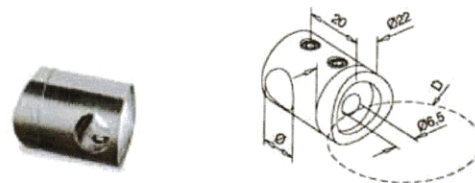
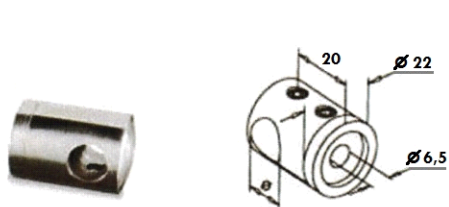

13

SOSTEGNI PER CORRENTI

**Sostegno passante per tondo**

Art.Nr.	Ø	D	Materiale
313F	10	PIATTO	Aisi 304
3136F	10	PIATTO	Aisi 316
312F	12	PIATTO	Aisi 304
3126F	12	PIATTO	Aisi 316
3126FL	12	PIATTO	Aisi 316 Lucido
311F	14	PIATTO	Aisi 304

Sostegno passante per tondo

Art.Nr.	Ø	D	Materiale
313D33	10	Ø33,7	Aisi 304
313D42	10	Ø42,4	Aisi 304
313D426	10	Ø42,4	Aisi 316
312D33	12	Ø33,7	Aisi 304
312D42	12	Ø42,4	Aisi 304
312D426	12	Ø42,4	Aisi 316
312D426L	12	Ø42,4	Aisi 316 Lucido
312D42Z	12	Ø42,4	Zama
312D48	12	Ø48,3	Aisi 304
311D33	14	Ø33,7	Aisi 304
311D42	14	Ø42,4	Aisi 304
311D48	14	Ø48,3	Aisi 304

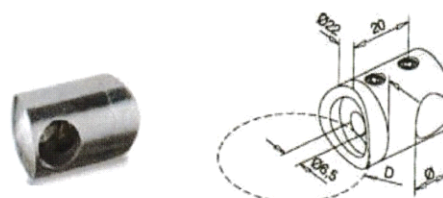
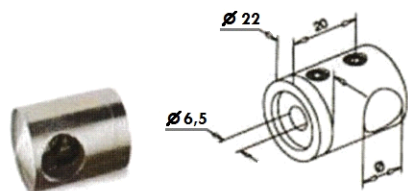
**Sostegno cieco sinistro per tondo**

Art. Nr.	Ø	D	Materiale
313FSX	10	PIATTO	Aisi 304
312FSX	12	PIATTO	Aisi 304

Sostegno cieco sinistro per tondo

Art. Nr.	Ø	D	Materiale
313D33SX	10	Ø33,7	Aisi 304
313D42SX	10	Ø42,4	Aisi 304
312D33SX	12	Ø33,7	Aisi 304
312D42SX	12	Ø42,4	Aisi 304
312D48SX	12	Ø48,3	Aisi 304

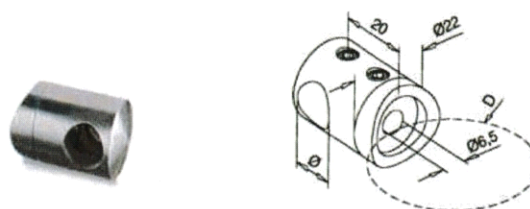
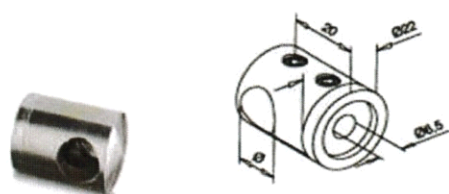
**Sostegno cieco destro per tondo**

Art. Nr.	Ø	D	Materiale
313FDX	10	PIATTO	Aisi 304
312FDX	12	PIATTO	Aisi 304

Sostegno cieco destro per tondo

Art. Nr.	Ø	D	Materiale
313D33DX	10	Ø33,7	Aisi 304
313D42DX	10	Ø42,4	Aisi 304
312D33DX	12	Ø33,7	Aisi 304
312D42DX	12	Ø42,4	Aisi 304
312D48DX	12	Ø48,3	Aisi 304

13 Sostegni laterali e centrali, snodi e terminali per correnti

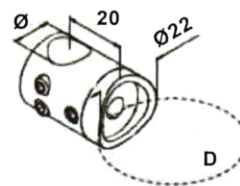
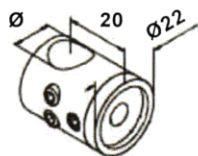

Sostegno di unione tondo

Art. Nr.	Ø	D	Materiale
313FU	10	PIATTO	Aisi 304
312FU	12	PIATTO	Aisi 304

Sostegno di unione tondo

Art. Nr.	Ø	D	Materiale
313D33U	10	Ø 33,7	Aisi 304
313D42U	10	Ø 42,4	Aisi 304
312D33U	12	Ø 33,7	Aisi 304
312D42U	12	Ø 42,4	Aisi 304

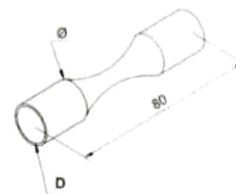
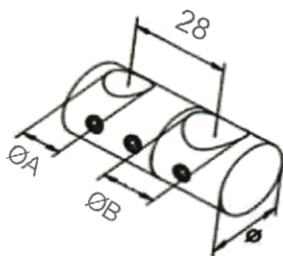

Supporto doppio per tondini

new

Art. Nr.	ØA	ØB	Ø	Materiale
312D10	10,2	10,2	22	Aisi 304
312D12	12,2	12,2	22	Aisi 304

Giunto tondo-tondo (da piegare)

new

Art.Nr.	D	Ø	Materiale
350D10	Ø10,2	12mm	Aisi 304
350D12	Ø12,2	14mm	Aisi 304
350D14	Ø14,2	16mm	Aisi 304

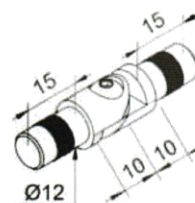
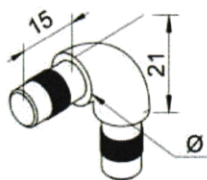

Curva M/M 90°

new

Art.Nr.	Ø	Materiale
160D12	Ø12x1,5mm	Aisi 304

Giunzione M/M snodata per tubetto

new

Art.Nr.	Ø	Materiale
250D12	Ø12x1,5mm	Aisi 304

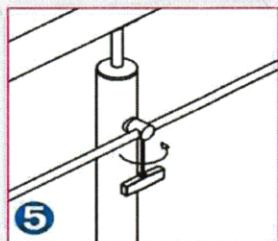
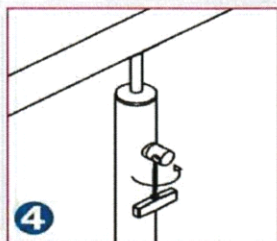
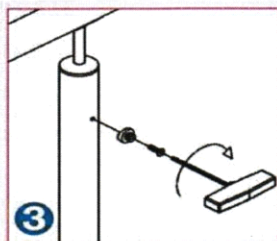
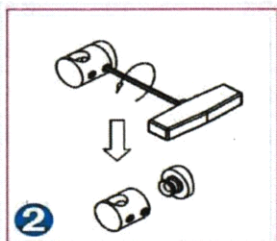
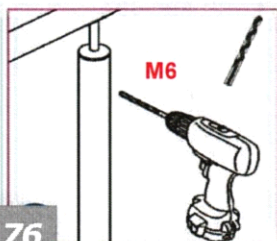

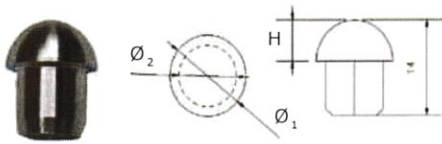

Tappo terminale semisferico

Art.Nr.	per tubo	Ø1	Ø2	H	Materiale
153	Ø10x1,5	10,0	7,0	6	Aisi 316
154	Ø12x1,5	12,0	9,0	6	Aisi 316

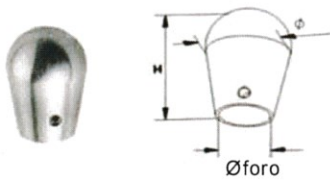
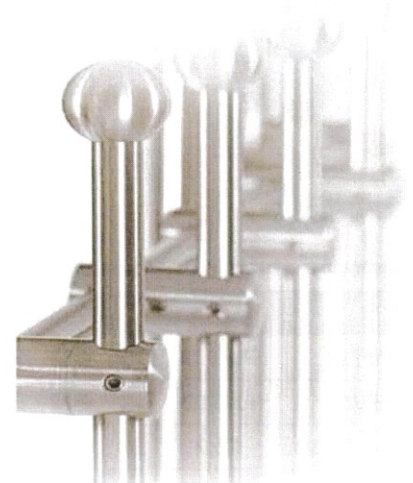

Calotta terminale conica per tondino *new*

Art. Nr.	Øforo	H	Ø	Materiale
155D10	10,2	30	19	Aisi 304
155D12	12,2	30	19	Aisi 304

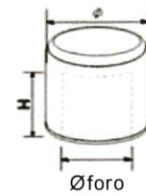

Calotta terminale piana per tondino *new*

Art. Nr.	Øforo	H	Ø	Materiale
157D10	10,2	15	13	Aisi 304
157D12	12,2	15	15	Aisi 304

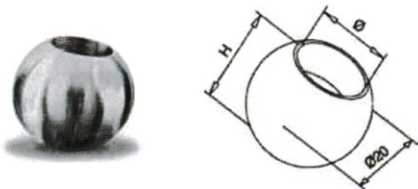

Terminale sferico per tondino

Art. Nr.	Ø	H	Materiale
317	10	18,5	Aisi 304
3176	10	18,5	Aisi 316
316	12	17,5	Aisi 304
3166	12	17,5	Aisi 316

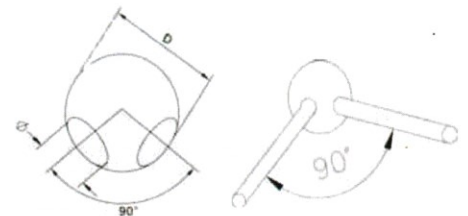

Terminale sferico angolare per 2 tondini

Art. Nr.	Ø	D	Materiale
317A90	10	20	Aisi 304
316A90	12	25	Aisi 304



13 Sostegni laterali e centrali, snodi e terminali per correnti

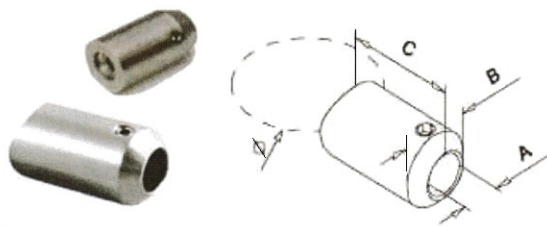

Sostegno centrale fisso per tondo

Art. Nr.	Ø	A	B	C	Materiale
315F/10	PIATTO	10	Ø22	35	Aisi 304
315F/12	PIATTO	12	Ø22	35	Aisi 304
315D33/10	33,7	10	Ø22	35	Aisi 304
315D33/12	33,7	12	Ø22	35	Aisi 304
315D42/10	42,4	10	Ø22	35	Aisi 304
315D42/12	42,4	12	Ø22	35	Aisi 304

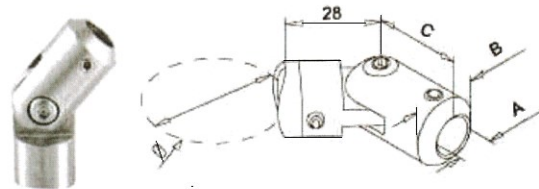

Sostegno centrale snodato per tondo ± 90°

Art. nr.	Ø	A	B	C	Materiale
309F/10	PIATTO	10	Ø22	32	Aisi 304
309F/12	PIATTO	12	Ø22	30	Aisi 304
309D33/10	33,7	10	Ø22	32	Aisi 304
309D33/12	33,7	12	Ø22	32	Aisi 304
309D42/10	42,4	10	Ø22	32	Aisi 304
309D42/12	42,4	12	Ø22	30	Aisi 304

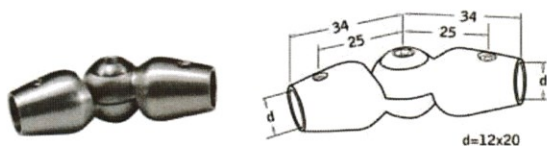

Giunzione snodata per tondo (±90°)

Art. Nr.	d	L _{tot}	Materiale
350	12	68	Aisi 304

(Fino ad esaurimento scorte)

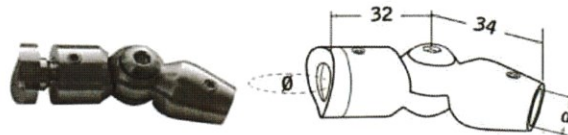

Attacco centrale snodato(+90°/-90°)

Art. Nr.	Ø	d	L _{tot}	Materiale
340	42,4	12	66	Aisi 304

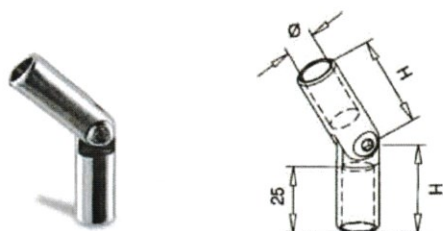

Giunzione a snodo (+90°/-90°)

Art. Nr.	Ø	H	Materiale
319	10 mm	35	Aisi 304
3196	10mm	30	Aisi 316
318	12 mm	36	Aisi 304
3186	12 mm	30	Aisi 316

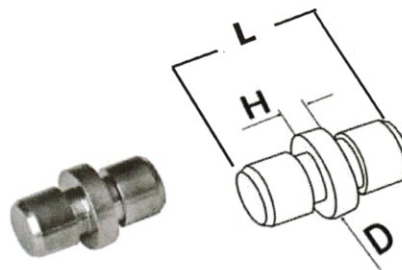

Connessione diritta per tubetto Sp.1,5mm

Art. nr.	D	H	L	Materiale
4AG1	10x1,5	2,5	18	Aisi 304
6AG1	10x1,5	2,5	18	Aisi 316
4AG2	12x1,5	3,0	20	Aisi 304
6AG2	12x1,5	3,0	20	Aisi 316

Giunzione snodata



Tondo/Tubetto
Innesto INTERNO

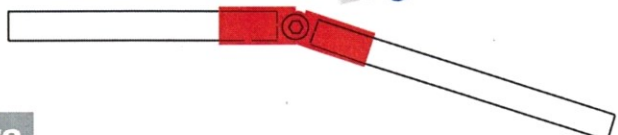

Connessione diritta



Tubetto
Innesto ESTERNO

