

ACCESSORI NAUTICI MICROFUSI LUCIDI (cod. IM)

Bloccaggio con grani

Attenzione! Le dimensioni riportate possono subire variazioni minime a seconda del lotto di produzione. Si consiglia di non praticare i fori prima di ricevere il prodotto.

BASE TONDA A 90° - A.316

Art. 8201

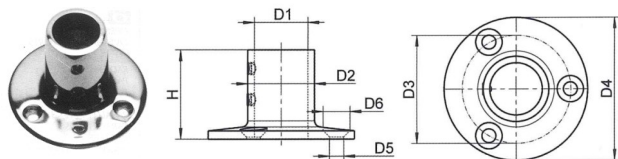

| Codice | D1 | D2 | D3 | D4 | D5 | D6 | H |
|--------|------|----|----|----|-----|------|----|
| | mm | mm | mm | mm | mm | mm | mm |
| 8201A | 22,5 | 29 | 50 | 66 | 5,3 | 10 | 43 |
| 8201B | 25,6 | 32 | 53 | 70 | 6,3 | 11,5 | 43 |

BASE TONDA A 60° - A.316

Art. 8202

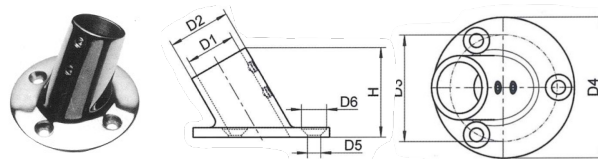

| Codice | D1 | D2 | D3 | D4 | D5 | D6 | H |
|--------|------|----|----|----|-----|------|----|
| | mm | mm | mm | mm | mm | mm | mm |
| 8202A | 22,5 | 29 | 50 | 66 | 5,3 | 10 | 43 |
| 8202B | 25,6 | 32 | 53 | 70 | 6,3 | 11,5 | 43 |

BASE RETTANGOLARE A 90° - A.316

Art. 8203

Versione a 60° su richiesta

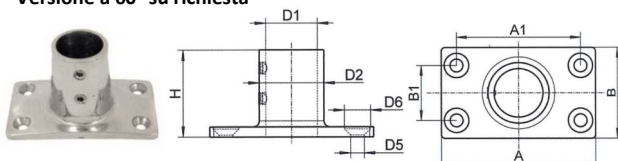

| Codice | A | A1 | B | B1 | D1 | D2 | D5 | D6 | H |
|--------|----|----|----|----|------|----|-----|------|----|
| | mm | mm | mm | mm | mm | mm | mm | mm | mm |
| 8203A | 76 | 60 | 44 | 27 | 22,5 | 29 | 5,3 | 10 | 43 |
| 8203B | 81 | 65 | 48 | 28 | 25,6 | 32 | 6,3 | 11,5 | 43 |

TEE A 90° - A.316

Art. 8205

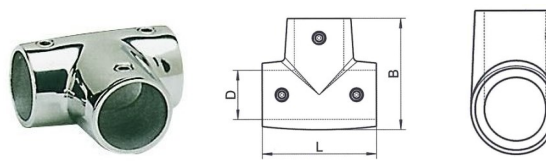

| Codice | B | D | L |
|--------|----|------|----|
| | mm | mm | mm |
| 8205A | 50 | 22,5 | 50 |
| 8205B | 53 | 25,6 | 53 |

TEE A 60° - A.316

Art. 8206

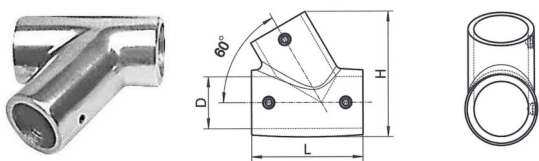

| Codice | D | L | H |
|--------|------|----|----|
| | mm | mm | mm |
| 8206A | 22,5 | 50 | 57 |
| 8206C | 25,6 | 55 | 62 |

SOSTEGNO PASSANTE A 60° - A.316

Art. 8207

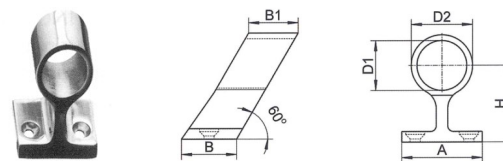

| Codice | A | B | B1 | D1 | D2 | H | Øfori | Svas. |
|--------|----|----|----|------|------|----|-------|-------|
| | mm | mm | mm | mm | mm | mm | mm | mm |
| 8207A | 40 | 26 | 20 | 22,5 | 30 | 37 | 5,3 | 10 |
| 8207B | 42 | 29 | 23 | 25,6 | 31,5 | 40 | 5,3 | 10 |

SOSTEGNO CIECO A 60° - A.316

Art. 8208

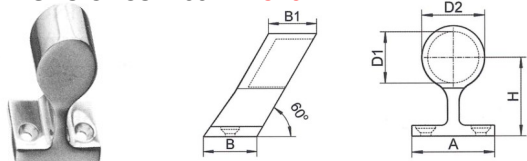

| Codice | A | B | B1 | D1 | D2 | H | Øfori | Svas. |
|--------|----|----|----|------|------|----|-------|-------|
| | mm | mm | mm | mm | mm | mm | mm | mm |
| 8208A | 40 | 26 | 20 | 22,5 | 28,5 | 37 | 5,3 | 10 |
| 8208B | 42 | 29 | 23 | 25,6 | 31,5 | 40 | 5,3 | 10 |

ANGOLARE A 90° - A.316

Art. 8210

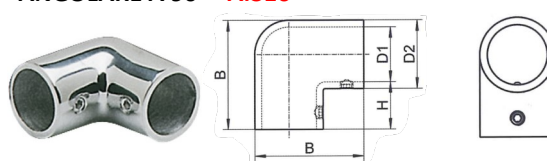

| Codice | B | D1 | D2 | H |
|--------|----|------|----|----|
| | mm | mm | mm | mm |
| 8210A | 49 | 22,5 | 29 | 23 |
| 8210B | 51 | 25,6 | 32 | 23 |

TRE VIE A 90° - A.316

Art. 8211

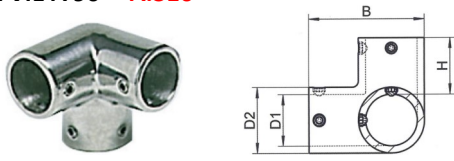

| Codice | B | D1 | D2 | H |
|--------|----|------|----|----|
| | mm | mm | mm | mm |
| 8211A | 49 | 22,5 | 29 | 23 |
| 8211B | 51 | 25,6 | 32 | 23 |

TAPPO TERMINALE - A.316

Art. 8216A

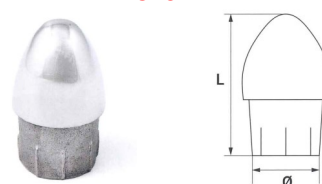

| Codice | Per tubo Ø | L |
|--------|------------|----|
| | mm | mm |
| 8216A | 22 | 40 |

Bloccaggio con grani

ACCESSORI NAUTICI MICROFUSI LUCIDI (cod. IM)

Attenzione! Le dimensioni riportate possono subire variazioni minime a seconda del lotto di produzione.
Si consiglia di non praticare i fori prima di ricevere il prodotto.

CAPPUCCIO TERMINALE - A.316

Art. 8270

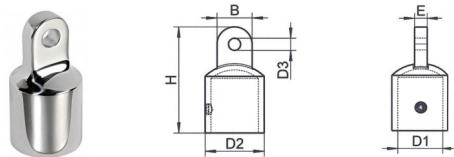

| Codice | B | D1 | D2 | D3 | E | H |
|--------|----|------|----|-----|----|----|
| | mm | mm | mm | mm | mm | mm |
| 8270A | 40 | 22,5 | 29 | 6,6 | 7 | 58 |
| 8270B | 42 | 25,6 | 32 | 6,6 | 7 | 58 |

SNODO A FORCELLA - A.316

Art. 8271

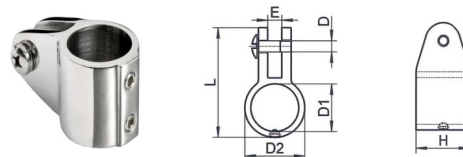

| Codice | D | D1 | D2 | E | H | L |
|--------|-----|------|----|-----|----|----|
| | mm | mm | mm | mm | mm | mm |
| 8271A | 6,6 | 22,5 | 29 | 7,5 | 7 | 51 |
| 8271B | 6,6 | 25,6 | 32 | 7,5 | 7 | 59 |

SNODO A FORCELLA BASE PIANA - A.316

Art. 8273

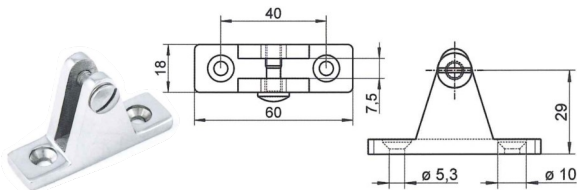

| Codice | Ø fori | Svasatura |
|--------|--------|-----------|
| | mm | mm |
| 8273 | 5,3 | 10 |

GANCIO CON UN FORO - A.316

Art. 8270

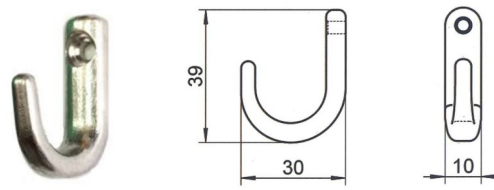

| Codice | Ø foro | Svasatura |
|--------|--------|-----------|
| | mm | mm |
| 8270 | 3,2 | 6 |

GANCIO CON DUE FORI - A.316

Art. 8399

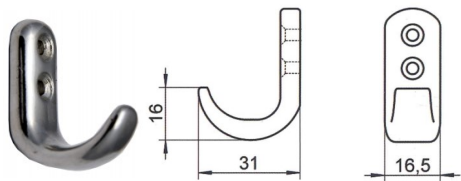

| Codice | Ø fori | Svasatura |
|--------|--------|-----------|
| | mm | mm |
| 8399 | 3,2 | 6 |

RAMPINO PER FINESTRE - A.316

Art. 8384

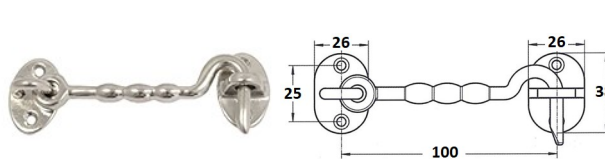

| Codice | Ø fori | Svasatura |
|--------|--------|-----------|
| | mm | mm |
| 8384 | 5,3 | 10 |

GANCIO PER PARABORDI - A.316

Art. 8375

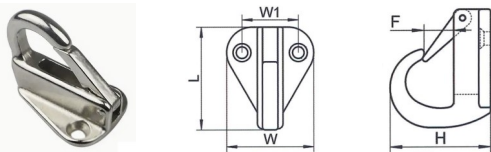

| Codice | F | H | L | W | W1 |
|--------|-----|------|----|----|----|
| | mm | mm | mm | mm | mm |
| 8375A | 9,5 | 26 | 37 | 33 | 20 |
| 8375B | 11 | 27,5 | 43 | 31 | 20 |

AERATORI - A.304

Art. 8057A

Art. 8057B

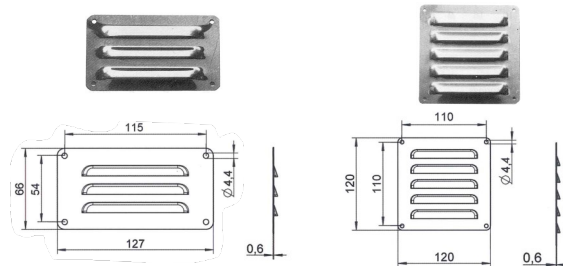

Art. 8057C

Art. 8057D

Art. 8057E

Art. 8057F

